

C1 Lathe

Parts Diagram & List

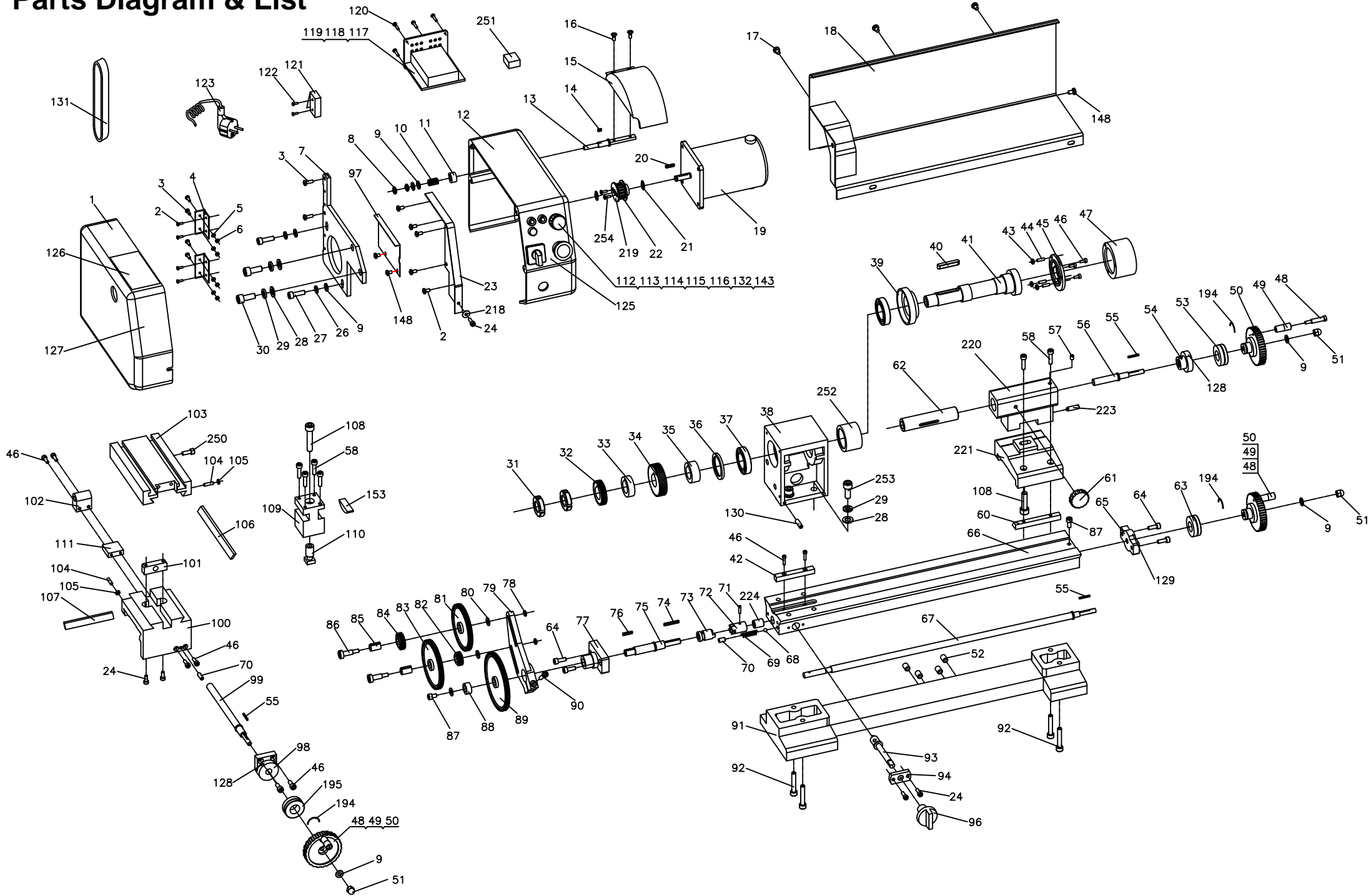

No.	Part Name	QTY
1	Change gear cover	1
2	Cap Screw GB818, M4*8	9
3	Cap Screw GB818, M4*12	6
4	Hinge L*B=38*31	1
5	Washer 4	4
6	Nut M4	4
7	Cantilever	1
8	Nut M6	2
9	Washer 6	7
10	Compression spring	1
11	Spacing ring	1
12	Cover for Spindle box	1
13	Rotate spindle	1
14	Key 3*6	1
15	Protect cover for chuck	1
16	Cap screw M4*8	2
17	Cap screw M5*8	3
18	Rear splash guard	1
19	Motor	1
20	Key 3*16	1
21	Check ring 8	2
22	Timing pulley	1
23	Support plate	1
24	Screw M4*10	5
26	Spring washer 6	2
27	Screw M6*20	2
28	Washer 8	6
29	Spring washer 8	6
30	Screw M8*20	2
31	Small round nut M18*1.5	2
32	Spindle gear	1
33	Spacing ring (I)	1
34	Spindle timing pulley	1
35	Spacing ring (II)	1
36	Behind oil seal(ring)	1
37	Bearing 30205	2
38	Spindle box	1
39	Front oil seal(ring)	1
40	Key 6*36	1
41	Spindle	1
42	Key	1
43	Nut M6	3
44	Screw M6*25	3
45	Chuck flange	1
46	Round cap screw M4*12	11

47	80mm 3-jaw chuck	1
48	Handle screw	3
49	Rotate small handle	3
50	Handwheel	3
51	Cap nut M6	3
52	Screw M8*12	4
53	Space ring	1
54	Screw base	1
55	Key 2*10	3
56	Tailstock screw	1
57	Screw M5*8	1
58	Screw M5*20	6
60	Wedge	1
61	Lock handle	1
62	Tailstock quill	1
63	Dial	1
64	Screw M5*14	4
65	Screw bracket	1
66	Bed lead rail	1
67	leadscrew	1
68	Steel ball 5	1
69	Compression spring	1
70	Screw M6*10	4
71	Pin 3*14	1
72	Clutch bracket	1
73	Clutch	1
74	Key 3*22	1
75	Shaft	1
76	Key 3*14	1
77	Gear shaft bracket	1
78	Nut M5	2
79	Support plate	1
80	Washer	3
81	Change gear Z=72	1
82	Change gear Z=19	1
83	Change gear Z=76	1
84	Change gear Z=24	1
85	Gear sleeve	2
86	Gear shaft	2
87	Screw M5*8	2
88	Spacing ring	1
89	Change gear Z=90	1
90	Screw M5*25	1
91	Bed base	1
92	Screw M6*35	4
93	Unplug shaft	1

94	Dam-board	1
96	Clutch rotate knob	1
97	Dam-board	1
98	Leadscrew bracket	1
99	Cross slide screw	1
100	Saddle	1
101	Cross slide nut	1
102	Leadscrew nut	1
103	Cross slide	1
104	Screw M4*16	7
105	Nut M4	7
106	Cross slide wedge	1
107	Gib strip	1
108	M8×35 Screw M8*40	2
109	Tool rest	1
110	Tool rest shaft	1
111	Connect block	1
112	Potentiometer	1
112	Potentiometer	1
113	Emergency stop switch	1
114	Forward/off/Reverse switch	1
115	Power indicator light	2
116	Fuse box	1
117	pc board	1
117	pc board	1
118	Lock connect	1
119	PC board box	1
120	Screw ST2.9*9.5	4

121	Micro switch	1
122	Screw ST2.2*9.5	2
123	Power line	1
125	Switch label	1
126	Change gear label	1
127	Main label	1
128	Scale label (I)	2
129	Scale label (II)	1
130	M5×20 Screw M5*20	4
131	Timing belt 1.5*83*10	1
132	Yellow lamp	1
143	Screw M4*6	1
148	Screw M4*6	3
153	Tool rest block	1
194	Spring	3
195	Dial	1
218	Big washer	1
219	Washer	1
220	Tailstock casting	1
221	Base plate	1
223	Screw M6*20	1
224	Bearing sleeve	1
250	Screw M8*35	1
251		1
252	Spacing ring	1
253	M8X25 Screw M8*25	4
254	M3×8 Screw M3*8	2